



IP CamSecure Pro Series Surveillance Management Software



FCS-94xx Series

Powerful Surveillance Management Software

LevelOne has developed intelligent and advanced featured surveillance management software that compliments our digital IP Surveillance Cameras. Features such as a Smart Guard system and Smart Search system allows for general monitoring of motion, missing objects, foreign objects and camera occlusion.

This Smart Guard and Smart Search system is currently the most advanced surveillance software available in the surveillance market.

Smart Guard and Smart Search

The most exciting new features of the IP CamSecure software are the Foreign Object and Missing Object reporting feature. When monitoring an area, any foreign objects that do not belong there, such as bags, boxes, cars and people will trigger an alarm. So too is the Missing Object feature a valuable inclusion to monitor specific objects within a monitoring area. Once these objects are removed, an alarm is triggered notifying users about unsolicited activity.

Instant Actions and Notifications

IP CamSecure has several notification features that enable a surveillance system to monitor and report on certain activities. Notification includes on-screen display, sounding alert, e-mail alert, phone call alert, digital signal out and P/T/Z pre-set go.

Optimized Surveillance

Most surveillance systems still rely on traditional analogue CCTV Cameras for monitoring protected areas. To incorporate both digital IP Cameras and analogue CCTV Cameras in one system not only maximizes efficiency but also adds digital surveillance functionality.

LevelOne IP CamSecure enables users to use both digital and analogue cameras in one system for maximizing surveillance investment without immediate replacement of currently used systems. The surveillance software supports digital and analogue to provide a complete monitoring and surveillance management system.



1. Exit
2. Minimize
3. Screen Division
4. Tool Bar
5. Crystal Ball
6. Information Window
7. P/T/Z Camera Control

Key Features

- Monitor up to 64 channels simultaneously
- Dual monitor supported for live view and playback simultaneously
- "Smart guard" event analysis and instant response to monitor larger areas more efficiently
- "Smart search" for easy locating of recorded events as well as multi-events viewer and filter
- Enhance images of recorded video
- "Counting application" for objects amount control
- Supports Web-based and 3G/PDA mobile remote monitoring
- Complete system and event log database
- Relies on hard disk drive storage instead of video tapes
- Broadcast live video over the Internet for remote viewing
- Support both digital and analogue cameras in one system
- Control pan/tilt/zoom features on cameras
- Support Digital Watermark and E-Map
- Supports H.264/MJPEG/MPEG4 compression
- Supports Wide Screen for 16:9 layouts
- Supports iCamSecure Apple App and iOS Safari)

Technical Specification

Max # of Cameras Live View, Monitor and Record

4 Channels:

FCS-9404 IP CamSecure Pro4 Mega

8 Channels:

FCS-9408 IP CamSecure Pro8 Mega

16 Channels:

FCS-9416 IP CamSecure Pro16 Mega

25 Channels:

FCS-9425 IP CamSecure Pro25 Mega

36 Channels:

FCS-9436 IP CamSecure Pro36 Mega

64 Channels:

FCS-9464 IP CamSecure Pro64 Mega

Compatibility

*Compatible with LevelOne IP cameras.

More IP cameras of other major manufacturers supported in FCS-94xx.

Multi-Language Embedded

Turkish, Traditional Chinese, Simple Chinese, Danish, Japanese, Hungarian, Spanish, Greek, French, Finnish, Russian, English, Thai, Czech, Slovak, Korean, Italian, Portugal Portuguese, Brazil Portuguese, German, Swedish, Bulgarian, Norwegian, Polish, Farsi and Hebrew.

Hybrid Camera Management

Monitor IP digital and CCTV analog cameras in one surveillance system

Triple Monitor

User able to monitor up to triple monitor display , it can be setup live view on Monitor 1 and Monitor 2 while watching playbacks on Monitor 3. but it needs to install two graphic cards into a computer.

Smart Guard

Events triggered by general motion detection, missing/ foreign object detection, signal lost, camera occlusion, lose focus, external input or system status

Motion Detection

Camera-based motion detection with image exclude filter for image areas of no interest in specific period

Smart Search

Search unusual events with specific parameters from recorded video

Alarm Notification

Play sound, send emails, send SMS message, make phone calls, PTZ PRESET GO, signal digital output, on screen display and instant recording.

Counting Application

Count how many times objects moving between different locations

Video Compression

MJPEG / MPEG-4

Audio

Support full duplex real time audio

User Account

Multiple user authentication levels with password restriction rules for unlimited users

Log Viewer

All unusual events ,system events by date/time and/or cameras

Recording

Continuous recording, manual recording/snapshot, record by schedule, record by digital input or triggered event, and record moving only (pre/post record buffer is up to 60 seconds).

3GPP/PDA

**Monitor in 3G/PDA mobile devices which are equipped with 3G video playback.

E-Map

it provides exclusive E-map function for users to upload the pictures of the monitoring locations.

Digital Watermark

The digital watermark technology allows to check if the recording files on IP CamSecure are modified or not.

DDNS

Support DtDNS and Dynu.

Upgrade

No extra charge required for the further upgrade

Playback

Simultaneously Playback

16 Channels

Image Enhancer

Improve recorded video to get better image during playback and can be applied during export

Search for Recordings

Search for recordings based on date, time or specific video parameters.

Playback

Controllable speed 1/16x~16x or frame by frame

Video Clip Export

Export single BMP/JPEG images to file or printer

Export video in AVI

P/T/Z and I/O

PTZ Support

Control of PTZ cameras and preset positions

Preset Patrolling

Multiple cameras patrolling

Go to Preset on Event

Yes

Input/Output Control

Support digital input/output control

Remote Access via Remote Client Application

Remote Client Application

Remote live Viewer/ Remote Playback

PTZ Support

Control of PTZ cameras

Max # of Cameras Live View

Up to 16 Channels from different servers

Max # of Cameras Playback

Up to 16 Channels

Remote Access via Web Browser

Max # of Cameras Live View

Up to 4 Channels

Minimum System Requirements

CPU

Intel Core 2 Duo E5300 or above

RAM

1GB or above

Mother Board

Intel 33/35 or 55/57 chip or above, MB vendor Asus, Gigabyte or Intel with Intel Chipset recommended

Video Card

ATI Radeon 4650 , nVIDIA GeForce GF-9600 or above (ATI recommended)

Hard Disk

250G or above

OS

MS Windows XP/Vista/Server 2008(32/64bit)/7

Supported Camera Models

IP CamSecure Pro Mega Series	
Model name	FCS-94 04/08/16/25/36/64
Camera Support	
LevelOne	FCS-0010, FCS-0020, FCS-0030, FCS-0040, FCS-1010, FCS-1030, FCS-1040, FCS-1050, FCS-1060, FCS-1070, FCS-1081, FCS-1081A, FCS-1091, FCS-1101, FCS-1121, FCS-1131, FCS-1141, FCS-1151, FCS-3000, FCS-0031, FCS-3021, FCS-3031, FCS-3051, FCS-3061, FCS-3071, FCS-3081, FCS-3091, FCS-4x00, FCS-4020, FCS-7011, WCS-0010, WCS-0020, WCS-0030, WCS-0040, WCS-1090, WCS-2010, WCS-2030, WCS-2040, WCS-2060, WCS-2070, FCS-4010, FCS-5011, FCS-5030, FCS-5041, FCS-5051, FCS-7111, FCS-8005, FCS-8006
ACTi	SED 2100, SED 2120, SED 2140, SED 2400, SED 2420, SED 2600, SED 2610, SEM 1110, ACM SERIES, CAM 5300, CAM 5130, CAM 5140, CAM 5150, CAM 5500, CAM 6100, CAM 6200, CAM 6500, CAM 6510, CAM 6520, CAM 6600, CAM 7100, CAM 7120, CAM 7200, CAM 7220, CAM 7300, CAM 7320, CAM 6620, SED 2310, SED2320, CAM 5200, CAM 5XXX, CAM 6220, CAM 6XXX, CAM 7XXX, SEM 1XXX
Arecont Vision	AV1300, AV2000, AV2100, AV3100, AV3130, AV5100, AV8180, AV8360
ATLANTIS LAND	A02-OIPCAM1, A02-OIPCAM2, A02-OIPCAM3, A02-IPCAM5, A02-IPCAM6, A02-IPCAM7, A02-IPCAM8, A02-IPCAM9, A02-IPCAM10, A02-IPCAM11, A02-IPCAM12, A02-IPCAM13, A02-IPCAM14, A02-IPCAM15, A02-IPCAM16, A02-IPCAM17
AXIS	205, 206, 206M, 206W, 207, 207W, 207MW, 209FD, 210, 210A, 211, 211A, 212, 213, 214, 215, 216FD, 221, 225FD, 231D, 232D, 240Q, 241Q, 241QA, 241S, 241SA, 242S, 2460, 233D
D-Link	DCS-6620, DCS-6620G, DCS-5220, DCS-5300, DCS-5300G, DCS-2120, DCS-3420, DCS-3220, DCS-3220G, DCS-2100, DCS-2100G, DVS-104, DVS-301, DCS-900, DCS-G900, DCS-950, DCS-950G
ETROVISION	EVxx10
Hitron	HNCB-E1SN, HNG-E1SAW054, HWD125MN, HECMC4V0C4
FINE	TCP-690, TCP-690DN, TCP-HP930, WB-8211SD, WB-8411, CDV-3V930, TCP-690U, TCP-HP930U, WB-8211SDU, CDV-3V930U, EP-936, EP-908, EP-601, EP-201, EP-221, EP-221DN
IQin	IQeye301, IQeye301m, IQeye301w, IQeye302, IQeye302w, IQeye303, IQeye303w, IQeye501, IQeye511, IQeye601, IQeye602, IQeye603, IQeye701, IQeye702, IQeye703, IQeye705, IQeye751, IQeye752, IQeye753, IQeye755
JVC	VN-C20U, VN-E4(U), VN-C205U, VN-C215U, VN-C655U
Lumenera	le045c, le045c-dn, le075c, le075c-dn, le165c, le165c-dn, le175c, le175c-dn, le259c, le275c, le275c-dn, le375c, le375c-dn, le11059c
MOBOTIX	M10D-Night, M12D-Sec, M12D-IT-DNight, M12D-Sec-Dnight, M12M-Web, M22M-IT, M22M-Sec, M22M-Sec-Night, D12Di-IT, D12Di-Sec
Panasonic	BB-HCM311, BB-HCM331, BB-HCM371, BB-HCM381, BB-HCE481, BB-HCS301, BB-HCM511, BB-HCM515, BB-HCM581, BL-C10, BL-C1, BL-C20, BL-C30, BL-C111, BL-C131, KX-HCM110, KX-HCM280A, WV-NP472, WV-NS324, WV-NF284, WV-NP1000, WV-NP1004, WV-NM100, WV-NP240, WV-NP244, WV-NS202, WV-NW484, WV-NW964
PiXORD	100, 120/126/128, 200/206, 201, 205, 207, 240, 241, 261, 262, 263, 300, 400/42X, 461, 463, 1000, 1401, 2000, 4000, 8504, 405, 405M, 410, 411/412
PLANET	ICA-510, ICA-700, ICA-151W, ICA-151, ICA-750, ICA-107W, ICA-107P, ICA-107
PROBE	IP Fixed Camera, IP PTZ Camera
SAMSUNG	C6475
SONY	SNC-DF40, SNC-DF70, SNC-P1, SNC-P5, SNC-RZ25, SNC-RZ50, SNC-RX550, SNC-CS50, SNC-CS3, SNC-Z20, SNC-RZ30, SNC-CS10, SNC-CS11, SNT-V704, SNC-RX530, SNC-DF50, SNC-DF80
TOSHIBA	IK-WB02A, IK-WR01A, IK-WB21A, IK-WB15A
VIVOTEK	VS 2101, VS 2401, VS 2402, VS 2403, VS 3100, VS 3101, VS 3102, VS 3102-XLTH, VS 3103, VS 3107, VS 3108, VS 6000, VS 6100, VS 6104, VS 7000, VS 7101, SD 6000, SD 6101, SD 61x2, FD 6000, FD 61x1, FD 61x2, TC 5330, TC 5331, TC 5630, TC 5631, IP 21x1, IP 21x2, IP 31x1, TLFN, IP 31x1, IP 31x2, IP 31x7, IP 31x8, IP 3129, IP 3132, IP 3133, IP 3134, IP 3135-PLNX, IP 3135, IP 3136-PLNX, IP 3136, IP 3137, IP 51x2, IP 51x4, IP 5104, IP 5114, IP 5124, IP 5134, IP 6000, IP 61x2, IP 61x4, IP 61x7, IP 6104, IP 6114, IP 6124, IP 6134, IP 7000, IP 71x4, IP 71x7, IP 7135, IP 7136, IP 7137, IP 7151, IP 7152, PT 31x2, PT 31x3, PT 31x4, PT 31x7, PT 31X2, PT 31X3, PT 3134, PT 51x4, PT 5104, PT 5114, PT 5124, PT 5134, PT 6000, PT 61x4, PT 6104, PT 6114, PT 6124, PT 6134, PT 7000, PT 7135, PT 7137, PZ 6000, PZ 61x2, PZ 61x4, IP 7131, IP 7132, IP 7138, IP 7139, VS 7100, FD7131, SD7151, IP7142
ZAVIO	D611E, D611A, D610A, F611E, F611A, F610A, V111T, S610A, F721E, F721A, F720A, F711E, F711A, F710A, F211A, F210A, F212A, F310A, F312A, M210A, M212A, M610A, M612A, F613A, F510E, F510W, F511E, F511W, F710E, D510E, D511E, M310A, M312A

*Please visit <http://global.level1.com> for the compatible product list.

**This feature depends on the mobile telecom service provided and the mobile phone model. LevelOne does not guarantee that this feature will work in all countries.

***The specification is subject to change. Please visit <http://global.level1.com> for the latest specification.

Product Diagram

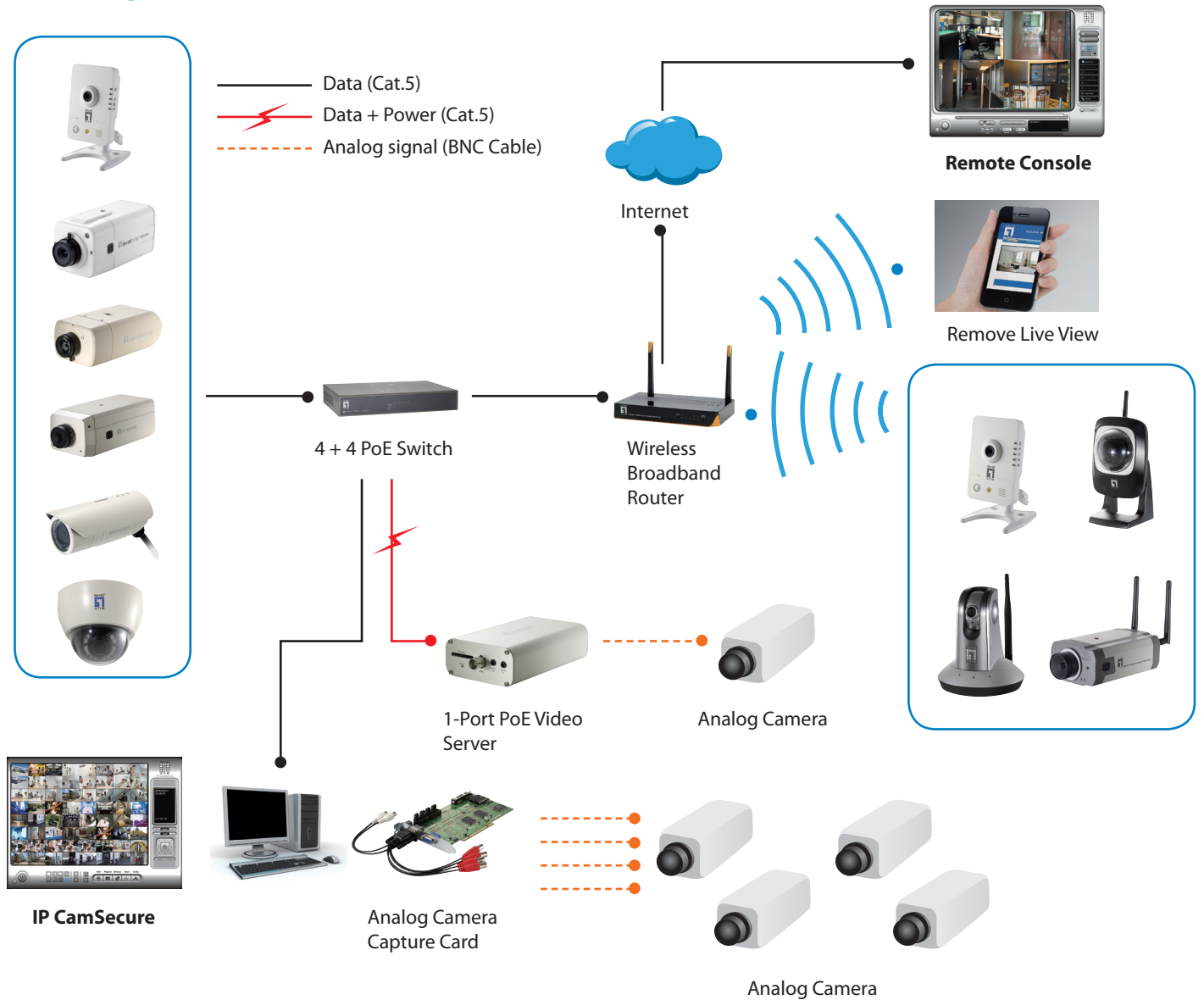

Order Information

- FCS-9404:** IP CamSecure Pro4 Mega
- FCS-9408:** IP CamSecure Pro8 Mega
- FCS-9416:** IP CamSecure Pro16 Mega
- FCS-9425:** IP CamSecure Pro25 Mega
- FCS-9436:** IP CamSecure Pro36 Mega
- FCS-9464:** IP CamSecure Pro64 Mega

Package Content

- CD Manual / Utility
- Quick Installation Guide