



## POI-2100 19 inch 8-slot PSE Rack for PIS-3100

### User's Manual

#### *Check your package contents*

---

The carton should contain the following items:

- POI-2100
- Power Cord

If any item is found missing or damaged, please contact your local reseller for replacement.

#### *Specification*

---

- Input voltage: 100-240VAC 50/60Hz 6/3A
- Material: SPCC with dark gray color painted.
- For 8 PSEs.
- Plug and play.

#### *Dimension*

---

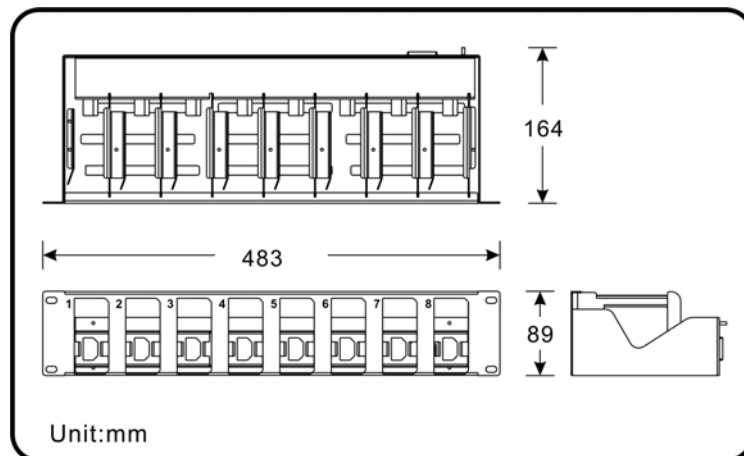

*Weight*

---

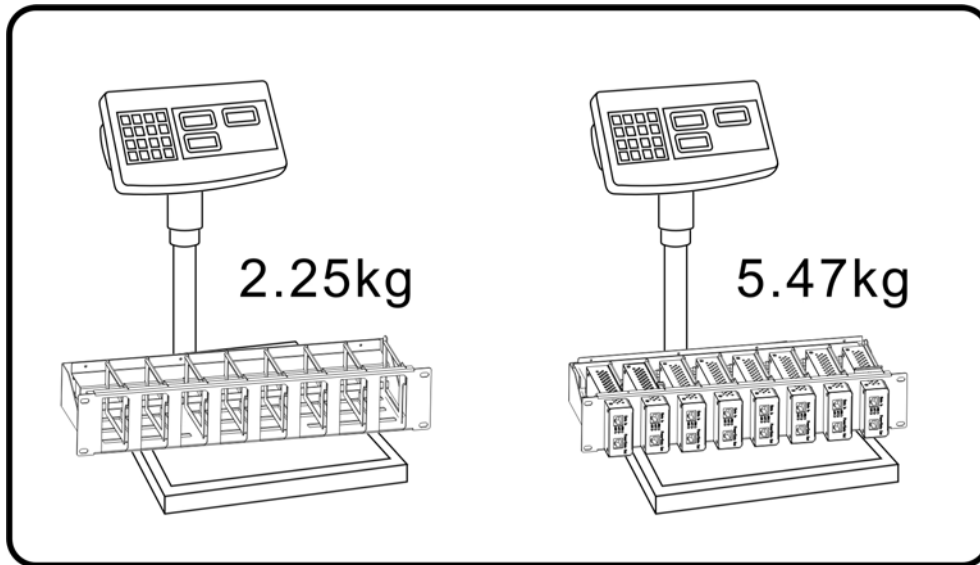

*Installation*

---

POI-2100 can either install on any 19" rack or to the wall and can install up to 8 PSEs.

**For 19" Rack:**

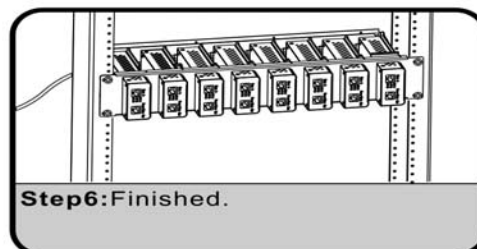
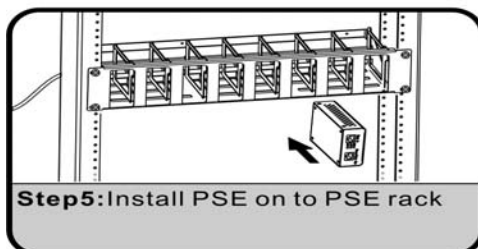
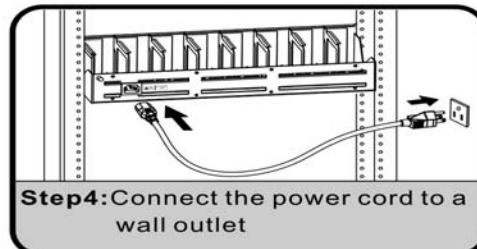
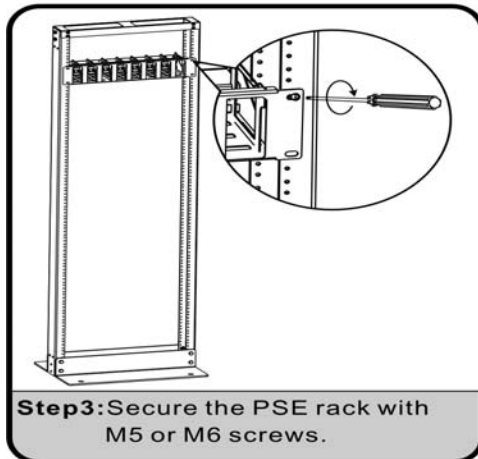
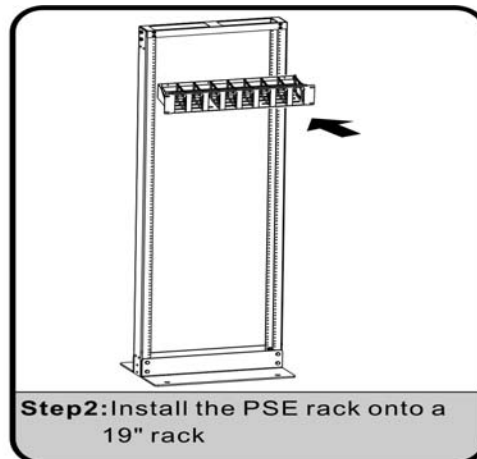
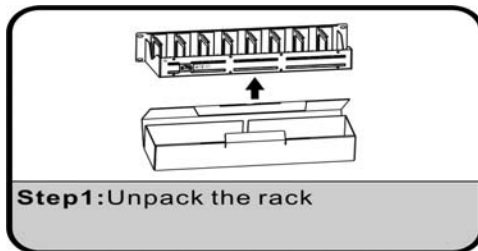



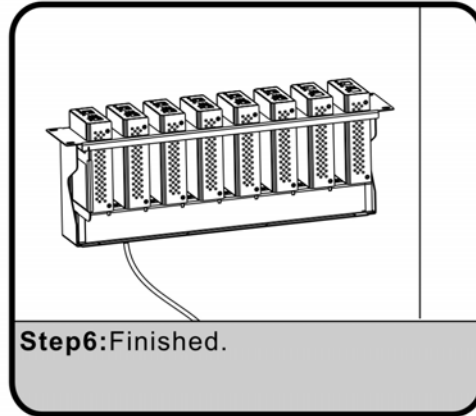
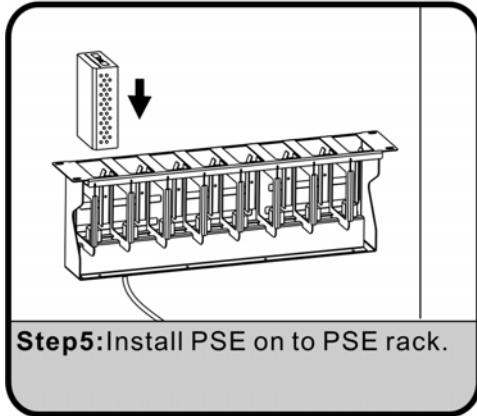
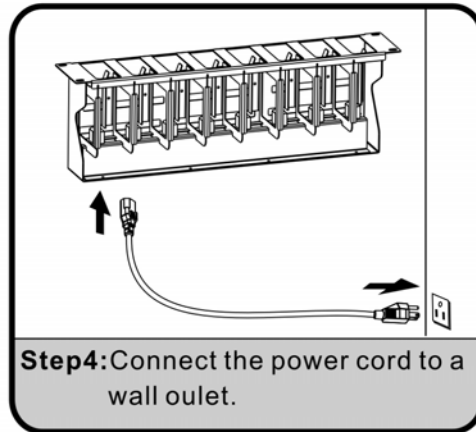
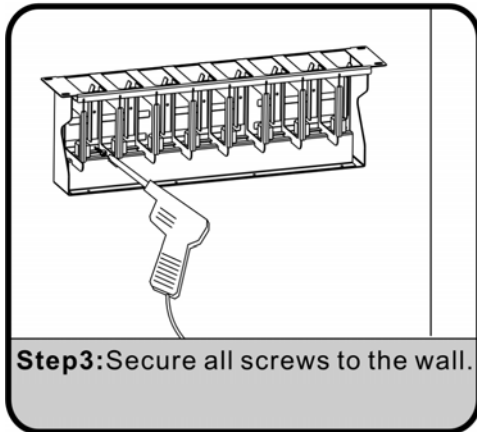
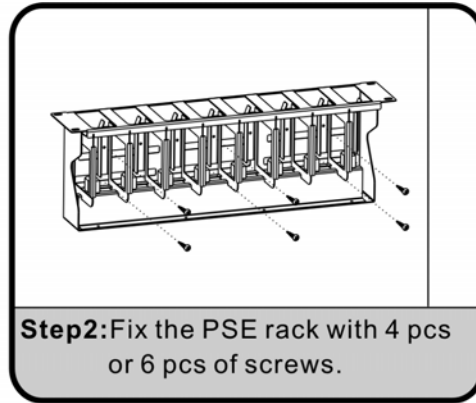
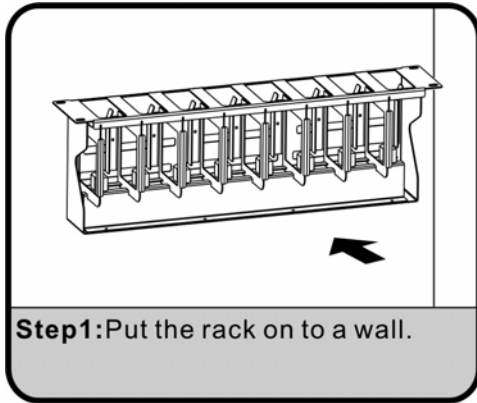

For wall:

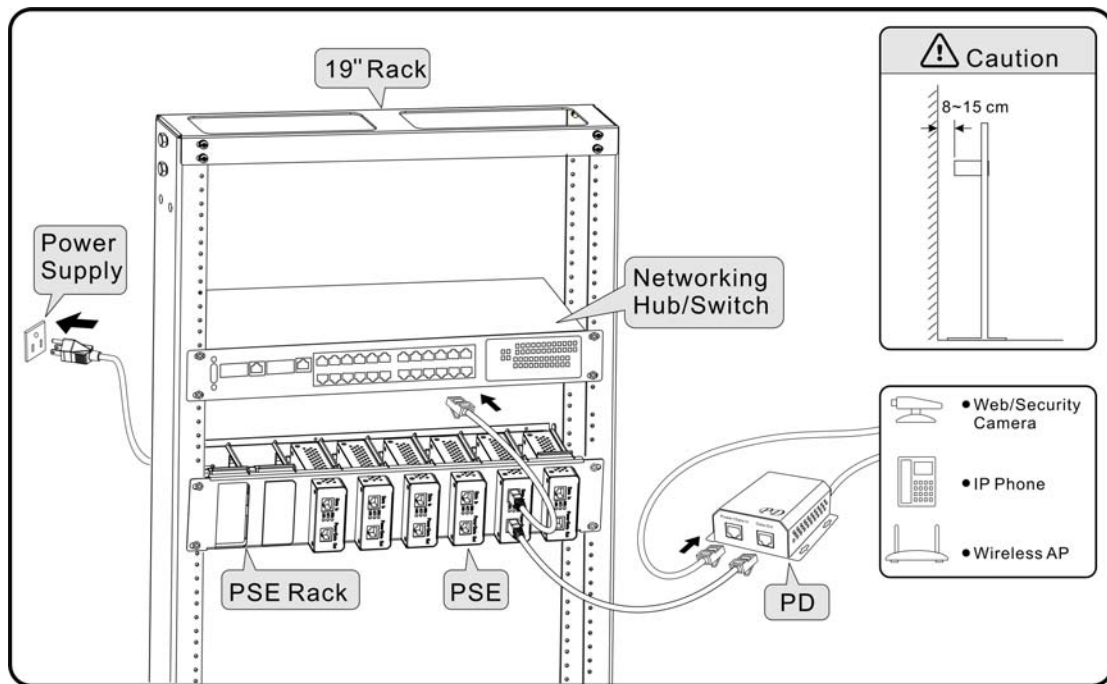

Connection demonstration

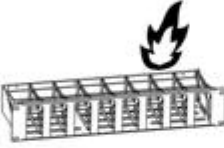

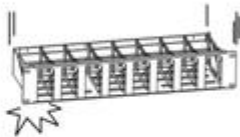
Warning and caution

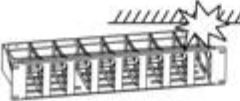
! Caution	
<p>Keep away from fire</p>  	<p>Prevent falling</p>  
<p>Prevent scratching</p>  	<p>Operating temperature</p> <p>5 °C - 40 °C</p>

 Warnings

Do not contact inside with metal



Do not dismantle. For authorized technical personnel only.

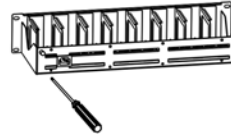

High voltage hazard.  
Do not touch conducting portion.



Do not hit with hard object

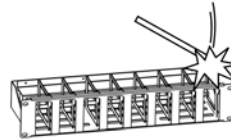

Do not clean with wet cloth



Do not overload the power outlet

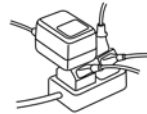

Do not touch with wet hand



Do not get wet

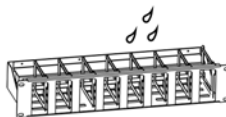

CE

